

SQUBE 2.0 ON 3 PHASE TRACK

20-Apr.-2019

2.0 LED

LED 12W | 220-240VAC | 50-60Hz | COB 3-step | incl. PS | phase-cut dim | incl. 3-phase track adapter

CE IP20 0,3m 24° 90° 355°

white texture	144364W
black texture	144364B

LIGHT COLOUR

2700K | >80CRI | 780lm 2

3000K | >80CRI | 810lm 4

1800-3000K | >80CRI | 850lm 9

OPTIONAL

dimmer

for switch

90019017

for din rail

90019018

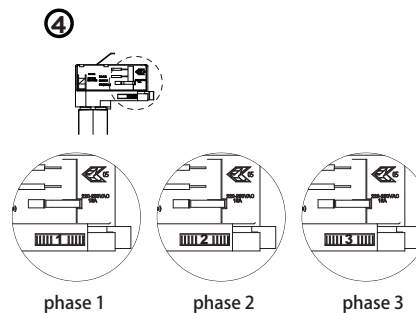
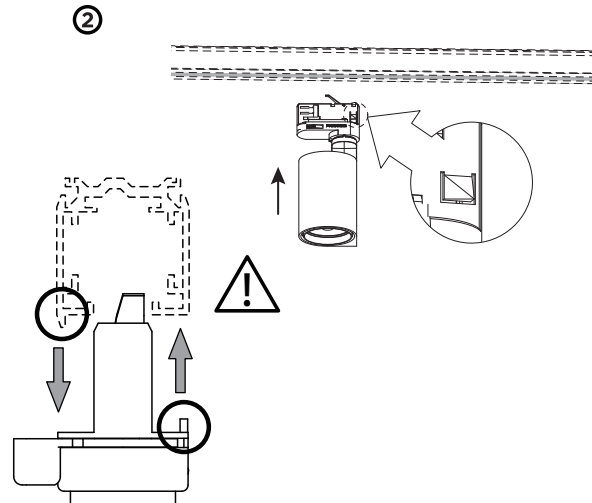
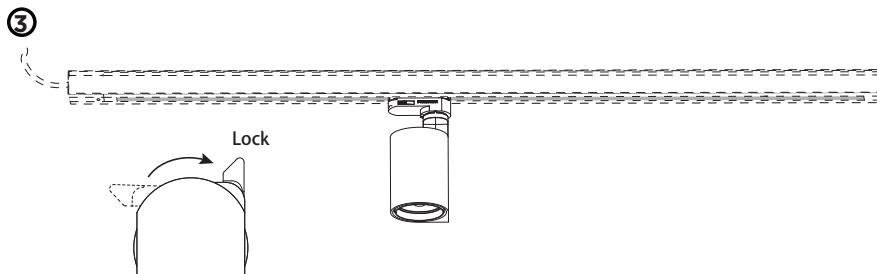
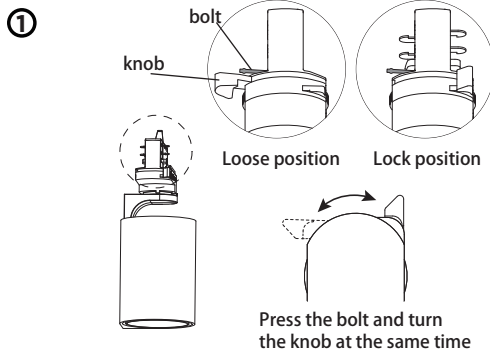

DIMENSIONS

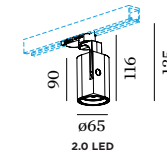

MOUNTING INSTRUCTION

- 1 Make sure the knob is on the Loose position.
- 2 Push the fixture into the track.
- 3 Turn the knob to the Lock position. (Press the bolt and turn the knob at the same time)
- 4 Select the phase.

The light source of the integrated LED is not replaceable;
When the light source reaches its end of life the whole
luminaire shall be replaced.



Caution, risk of electric shock